

TRUE TEMPER PART NO.	A		B		C		D		FINISHED WEIGHTS-g	
	FIN. LENGTH	TOL.	CENTER LENGTH	TOL. REF	LONG BUTT SECTION	TOL.	DRAWN LENGTH	TOL.	TOP	BOTTOM
FRAME SET	20.87 [530.0]	±.063 [1.6]	13.19 [335.0]		3.43 [87.0]		22.87 [580.8]		178.91	191.57
SHORT	22.44 [570.0]		15.08 [383.0]		3.11 [79.0]		24.44 [620.8]		190.88	204.34
MEDIUM	23.23 [590.0]		15.87 [403.0]		3.11 [79.0]		25.23 [640.8]		197.17	211.03
LONG	23.03 [585.0]		14.65 [372.0]		4.13 [105.0]		25.03 [635.8]		197.61	211.37
VERSATILE										196.21

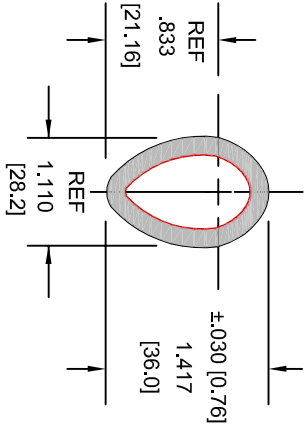
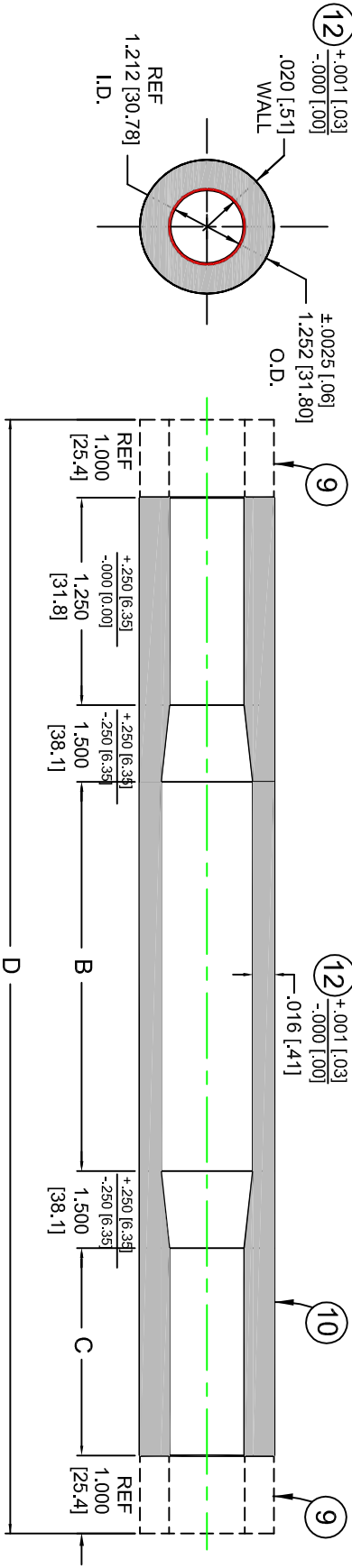

**NOTES**

- 12 TO ALLOW FOR POLISHING, DRAW TUBE WITH WALL THICKNESS AT TOP TOLERANCE: .021 / .017 / .021
- 11 PACKAGING: PBST30
- 10 PAINT MARK
- 9 DRAWN OVER-LENGTH AND CUT TO FINISHED LENGTH AFTER INSPECTING FOR PROFILE
- 8 USE SAME SHAPE DIE AS HEVLDT2 (DWG# 505-90193-1)
- 7 HEAT TREAT: OUTSIDE SOURCE
- 6 SURFACE COATING: OIL
- 5 SURFACE FINISH: POLISHED
- 4 HARDNESS: Rc 32-37
- 3 TRR: .040
- 2 MATERIAL: OX PLATINUM (6330)
- 1 PART MADE TO TRUE TEMPER PROCEDURE AND TESTS STANDARDS.

REV	BY	DATE	CHANGE
A	AR	7/20/02	INITIAL PRODUCTION RELEASE
B	AR	10/1/02	ADD MANUFACTURING NOTE
C	AR	5/25/10	ECR 10019 REMOVE NOTE CONCERNING FINAL SHAPE BY USE OF PLATES. FINISHED DIMENSIONS ARE ACHIEVED WITH DIE.

**TRUE TEMPER** 8275 TOURNAMENT DRIVE SUITE 200 MEMPHIS, TN 38125 (901) 746-2000

DRAWN BY: A. RANDOLPH  
CORPORATE: G. HORNWOOD  
MFG. ENGINEERING:

DESCRIPTION: TRUE TEMPER S3 BIKE FRAME TEAR SHAPED TOP TUBE SETS

PART FAMILY: S3 TOP TUBE SETS

QUALITY ASSURANCE: T. FARRELL  
DATE: 7/20/02  
SCALE: NONE  
EQU NUMBER: 10019  
SIZESHEET: A/1

WORK ORDER NUMBER: RFO 634C  
DRAWING NUMBER: AST-21-02

TOLERANCES (EXCEPT AS NOTED): DECIMAL  
.X +/- 0.125  
.XX +/- 0.063  
.XXX +/- 0.002

STEP LOCATION (FROM TIP): +/-.0063 (NON ACCUMULATIVE)

REVISION: C

THIS DOCUMENT IS THE PROPERTY OF TRUE TEMPER SPORTS. THE CONTENTS OF THIS DOCUMENT ARE CONFIDENTIAL AND CONSTITUTE TRADE SECRETS PROPRIETARY TO TRUE TEMPER SPORTS. NEITHER THIS DOCUMENT NOR ITS CONTENTS SHALL BE DISCLOSED TO ANY UNAUTHORIZED PERSON OR COPIED, OR PUBLISHED WITHOUT TRUE TEMPER SPORTS PRIOR WRITTEN CONSENT.