

TRUE TEMPER PART NO.	A		B		C		D		FINISHED WEIGHTS-g		
	FIN. LENGTH	TOL. ±	CENTER LENGTH	TOL. REF	LONG BUTT SECTION	TOL. ±	DRAWN LENGTH	TOL. ±	MEAN	TOLERANCE	
FRAME SET	20.87 [530.0]	±0.063 [1.6]	13.19 [335.0]		3.43 [87.0]	+2.5 [6.35] / -0 [0]	22.87 [580.8]	±0.063 [1.6]	178.91	191.57	177.55
SHORT	HS3TTS								178.91	191.57	177.55
MEDIUM	HS3TMM		15.08 [383.0]		3.11 [79.0]		24.44 [620.8]		190.88	204.34	189.50
LONG	HS3TLL		15.87 [403.0]		3.11 [79.0]		25.23 [640.8]		197.17	211.03	195.77
VERSATILE	HS3TTV		14.65 [372.0]		4.13 [105.0]		25.03 [635.8]		197.61	211.37	196.21

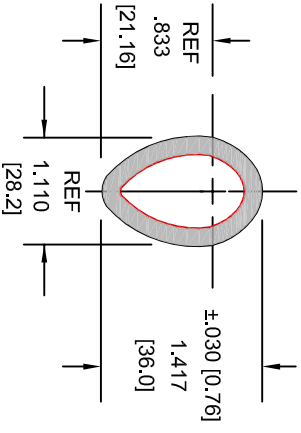
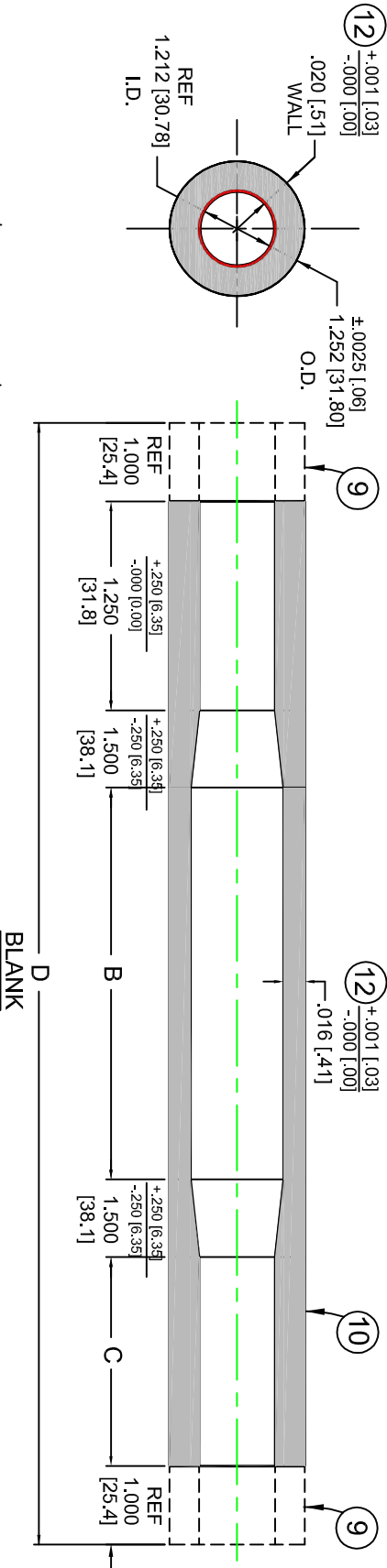

NOTES

12 TO ALLOW FOR POLISHING, DRAW TUBE WITH WALL THICKNESS AT TOP TOLERANCE: .021 / .017 / .021

11 PACKAGING: PBST30

10 PAINT MARK

9 DRAWN OVER-LENGTH AND CUT TO FINISHED LENGTH AFTER INSPECTING FOR PROFILE

8 USE SAME SHAPE DIE AS HVELDT2 (DWG# 505-90193-1)

7 HEAT TREAT: OUTSIDE SOURCE

6 SURFACE COATING: OIL

5 SURFACE FINISH: POLISHED

4 HARDNESS: Rc 32-37

3 TIR: .040

2 MATERIAL: OX PLATINUM (6330)

1 PART MADE TO TRUE TEMPER PROCEDURE AND TESTS STANDARDS.

REV	BY	DATE	CHANGE
A	AR	7/20/02	INITIAL PRODUCTION RELEASE
B	AR	10/1/02	ADD MANUFACTURING NOTE
C	AR	6/25/10	ECR 10019 REMOVE NOTE CONCERNING FINAL SHAPE BY USE OF PLATES. FINISHED DIMENSIONS ARE ACHIEVED WITH DIE.

TRUE TEMPER 8275 TOURNAMENT DRIVE SUITE 200 MEMPHIS, TN 38125 (901) 746-2000

DESCRIPTION: TRUE TEMPER S3 BIKE FRAME TEAR SHAPED TOP TUBE SETS

PART FAMILY: S3 TOP TUBE SETS

WORK ORDER NUMBER: RFO 634C AST-21-02

DRAWING NUMBER: REVISION

QUANTITY ASSURANCE: T. FARRELL

DATE: 7/20/02

SCALE: NONE

ECN NUMBER: 10019

SIZESHEET: A / 1

STEP LOCATION (FROM TIP): +/-.003 (NON ACCUMULATIVE)

TOLEANCES (EXCEPT AS NOTED): DECIMAL X +/- 0.125 XX +/- 0.063 XXX +/- 0.002

THIS DOCUMENT IS THE PROPERTY OF TRUE TEMPER SPORTS. THE CONTENTS OF THIS DOCUMENT ARE CONFIDENTIAL AND CONSTITUTE TRADE SECRETS PROPRIETARY TO TRUE TEMPER SPORTS. NEITHER THIS DOCUMENT NOR ITS CONTENTS SHALL BE DISCLOSED TO ANY UNAUTHORIZED PERSON OR COPIED, OR PUBLISHED WITHOUT TRUE TEMPER SPORTS PRIOR WRITTEN CONSENT.