

TRUE TEMPER PART NO.	FINISHED WEIGHTS-g	
	TOP	BOTTOM
HS3TT-R	MEAN TOLERANCE	TOLERANCE
	207.18	220.9
		205.28

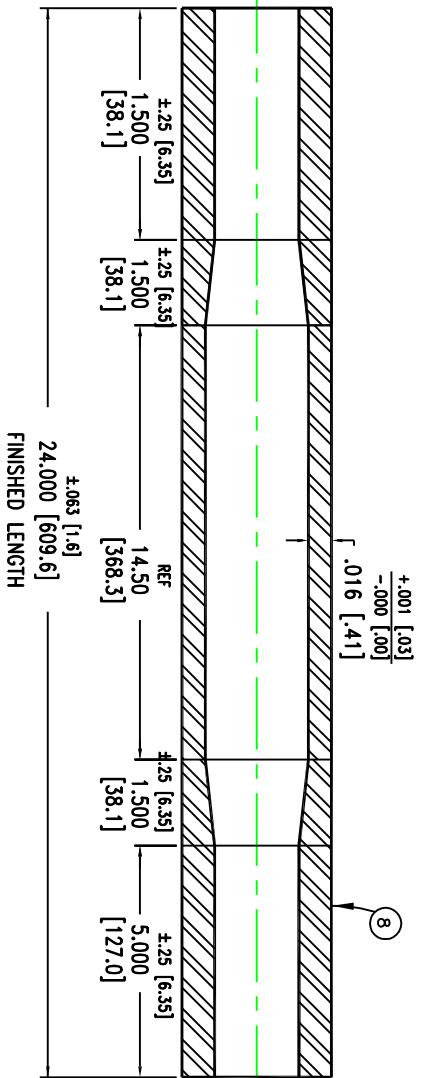
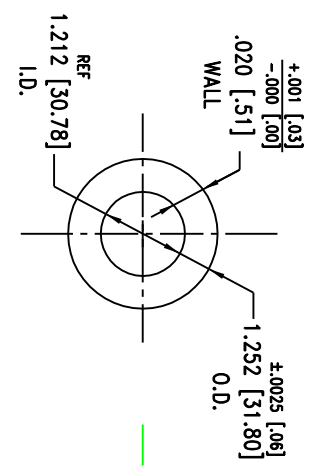

NOTES

- 1 PAINT MARK THIS END
- 2 HEAT TREAT TO Rc 37-43
- 3 SURFACE COATING: OIL
- 4 SURFACE FINISH: POLISHED
- 5 HARDNESS: Rc 32-37
- 6 TIR: .040
- 7 MATERIAL: OX PLATINUM
- 8 PART MADE TO TRUE TEMPER PROCEDURE AND TESTS STANDARDS.

NOTES

A		INITIAL PRODUCTION RELEASE	
BY	AR	DATE	6/9/03
RBV		CHANGE	

TRUE TEMPER
 8275 TOURNAMENT DRIVE
 SUITE 200
 MEMPHIS, TN 38125 (901) 746-2000

TRUE TEMPER
 S3 BIKE
 ROUND TOP TUBE

PART FAMILY: **HS3TT-R**

DESCRIPTION: TRUE TEMPER S3 BIKE ROUND TOP TUBE

DRIVEN BY: A. RANDOLPH
 B. HILL
 MFG. ENGINEERING
 T. GRIFFITH
 PRODUCTION CONTROL

QUALITY ASSURANCE: E. STEPHENS
 DATE: 2/25/03

WORK ORDER NUMBER: **RFQ 934** DRAWING NUMBER: **AST-04-03**

TOLERANCES (EXCEPT AS NOTED) REVISION: **1**

SCALE: NONE
 DECIMAL: .XX +/- 0.125
 .XXX +/- 0.063
 STEP LOCATION (FROM TIP) +/- 0.063 (NON ACCUMULATIVE)

THIS DOCUMENT IS THE PROPERTY OF TRUE TEMPER SPORTS. THE CONTENTS OF THIS DOCUMENT ARE CONFIDENTIAL AND CONSTITUTE TRADE SECRETS PROPRIETARY TO TRUE TEMPER SPORTS. NEITHER THIS DOCUMENT NOR ITS CONTENTS SHALL BE DISCLOSED TO ANY UNAUTHORIZED PERSON OR COPIED, OR PUBLISHED WITHOUT TRUE TEMPER SPORTS PRIOR WRITTEN CONSENT.